

Glass for toothbrush with wall support

- Glass for toothbrush with wall support in chrome plated brass.
- Durability and resistance to corrosion.
- Polish finish.



TECHNICAL DATA

- Support made of chrome plated brass.
- Dimensions: 50 high x 72 wide x 111 deep mm (without glass). Wall support Ø 50 mm.
- Hidden anchor mechanism. Wall fixing materials included.

SUGGESTED TEXT FOR PRESCRIPTION

Glass for toothbrush with wall support NOFER or similar, in chrome plated brass. Polish finish. Dimensions: 50 high x 72 wide x 111 deep mm. Wall support Ø 50 mm.

TECHNICAL DRAWING

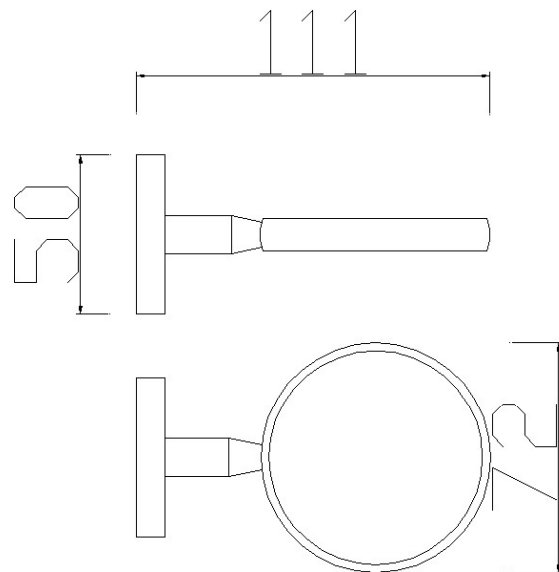

Dimensions in mm



NOFER S.L.  
 Avenida de la fama, 118  
 08940 · Cornellà de Llobregat (Barcelona)  
 Tel +34 934 742 423 · Fax +34 934 743 548  
 nofer@nofer.com · www.nofer.com

Related Products

