

Toilet brush

- Stainless steel toilet brush.
- Satin finish.
- Suitable for collectivities.
- Resistance and durability against corrosion.
- Rear fixing plate included.

TECHNICAL DATA

- Made in satin finished stainless steel.
- Dimensions: 377 height, Ø100 (mm).
- Thickness of the sheet: 0,5 (mm).
- Two wall fixing drills. Fixing materials included.
- Internal cup made of white polypropylene (dimensions: 140 mm height, Ø 86 mm).

SUGGESTED TEXT FOR PRESCRIPTION

NOFER toilet brush, in stainless steel satin finish. Dimensions: 377 height, Ø100 (mm).

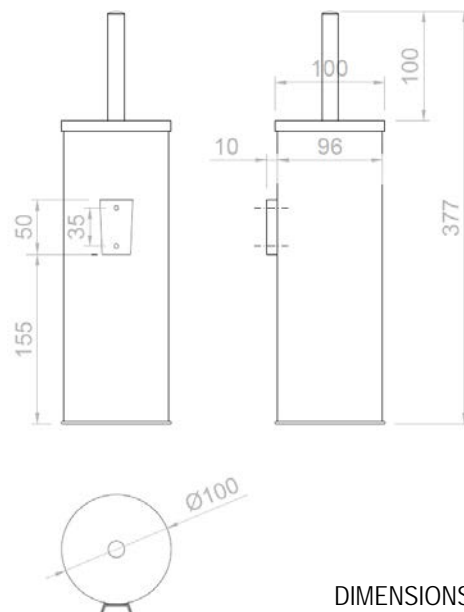
TECHNICAL DRAWING

DIMENSIONS IN mm



NOFER S.L.
 Avenida de la fama, 118
 08940 · Cornellà de Llobregat (Barcelona)
 Tel +34 934 742 423 · Fax +34 934 743 548
 nofer@nofer.com · www.nofer.com

Related products

